

KD VALVE

Severe Service Metal Seated Ball Valve

www.kdvalve.com

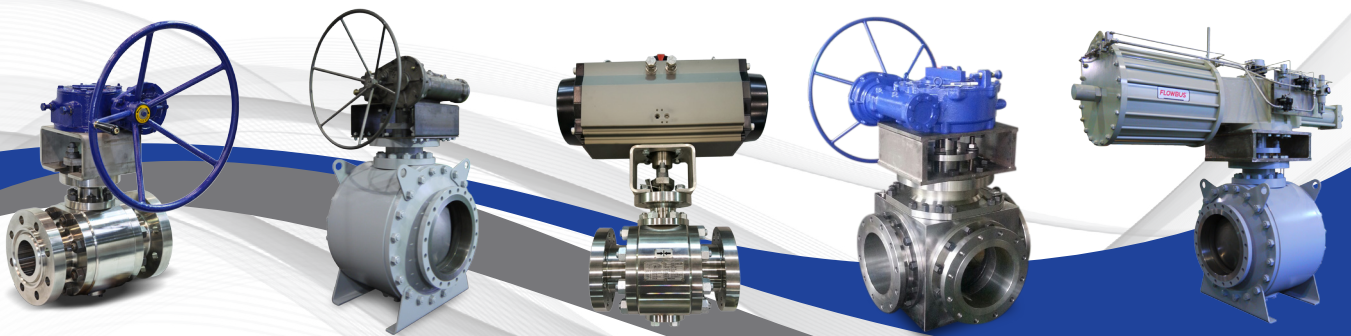

About KD

Workers at KD VALVE realized that the current metal seated ball valves being used by plants are neither efficient nor sufficient to cover the severe conditions and requirement of such industries. We began our long pursuit of research and development in order to bring a product that will change and improve the users' production. KD VALVE has developed under our own metallurgical technologies and has features implemented to operate under the most severe and harsh

conditions. The highest hardness with over HV 2000 enables it to serve the industry for extended lifetime and work under any circumstance as it is anti-corrosion and anti-erosion, and handles high temperature and heavy liquids under high pressure or any drop in it. Moreover, our unique pocketless design gives it a complete sealing with Zero-leakage and Zero-Bubble tight shut off. With extended lifecycle due to our innovation, you can expect lower costs to maintain.

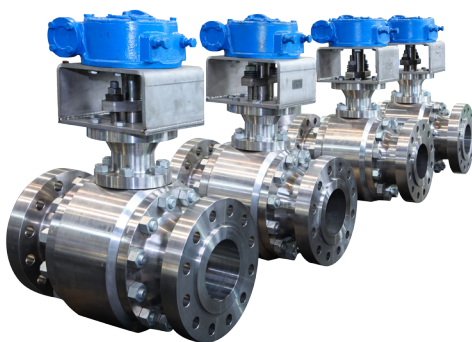

MISSION

KDVALVE provides a better future for the global energy industry with innovative severe service metal seated ball valve.

VISION

World's Leading Company to Control Valve Solution and Engineering Service by 2030

Benefits

Clients currently using our metal seated ball valves are experiencing beyond expected results, so they are satisfied with our products. Products from KD VALVE are a great solution if you are suffering from leakage, corrosion, erosion, cracking or long downtime, and high maintenance costs. All of them can be eliminated once you choose us as a partner and let us deliver the high performance of KD VALVE with its unique features.

Zero-leakage

Higher production rates as our Zero-leakage feature will eliminate any wasted material.

Lower cost of ownership

We can reduce maintenance costs as the life of our products has drastically extended than any other brand in the market.

Customized handmade product

We can provide the perfect valve for your plant to make operating the plants go smoothly. All of our valves produced are unique as they are designed to fit a certain customer's plant requirement.

Quality. Quality. Quality.

Our core principle and value is to cherish quality and provide the best product ever. Our team of experts performs rigorous and strict quality control on every unit manufactured to ensure every single piece you ordered is 100 percent inspected.

Safety

KD VALVE works under a strict principle to provide the safest product ever. We have conducted many tests on our products to ensure that they can perform well even under emergency situations.

Products



Metal Seated Ball Valve for High Temperature Service

KD VALVE is available in design for High temperature service up to +700°C, equipped with special designed stem and packings and live loaded seat design. KD VALVE is available in Metal to Metal seat design to endure High temperatures of up to +700°C, equipped with a special designed stem, packings, and loaded seat design. A valve is designed to allow high temperature isolation work, and the actuator, or operation part, is designed to be protected from high temperature service.

Metal Seated Ball Valve for High Abrasive and Erosion Service

KD VALVE is equipped with special designed scraper seat and high hardness material. These are to prevent that damage from service fluid and erosion from inside passing. KD VALVE is available in Metal to Metal seat design for Abrasive and Erosion Service, equipped with special designed scraper design seat and high hardness material. The valve ball and seat is of high hardness material, and is not easily damaged from the service fluid. Bidirectional sealing and the scraper seat design enable KD VALVE's products to maintain the sealing and long-term operation. These are to prevent the damage from service fluid and erosion from inside passing.



Metal Seated Ball Valve for Polysilicon Service

KDVALVE is available in Metal to Metal seat design for Poly-Silicon Industries. The Scraper seat design and high hardness gives the durability and the properties necessary to operate under the severe conditions. The Valve ball is not easily damages by MGSi powder so it can give you best-in-class lifecycle. The valve also features Pocketless Design which eliminates the dead space that allows the powder to build up for a smooth valve operation and seat closure.

Segment Metal Seated Ball Valve for Powder Line Service

KD VALVE's segment ball valve is superior performance in terms of powder, catalyst, such as a particle. KD VALVE is available in Segment Metal to Metal seat design for high performance application, equipped with special designed scraper and spring loaded seat. KD VALVE's segment ball valve is superior performance in terms of powder and catalysts, such as a particle. The scraper seat design makes possible long-term operation by removing the fluid surface of the ball during valve operation.

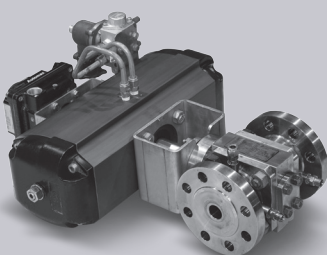

Steam Jacketed Metal Seated Ball Valve for High Performance Service

KD VALVE's steam jacketed ball valve, designed to effectively maintain the temperature of the media. Jacketed ball valve design is Side entry split type valve body, it is safer than end entry type valve body.



Flush Bottom Tank Metal Seated Ball Valve for High Abrasive Service

KD VALVE's Flush Bottom Tank Metal Seat Ball Valve is a trunnion mounted ball design with split forged body housing and integral stem. The spring loaded scraper seat system and live loaded stem packing also provide continuous tightness during rapid temperature changes.

Metal Seated Ball Valve for Fugitive Emission Service

KD VALVE is available in Metal to Metal seated design for Fugitive Emission environment, equipped with special designed a multi-layer stem packing.

KD VALVE has conducted a helium gas test for fugitive emission. And, the company has a lot of experience in processing hydrogen.



Actuated Metal Seated Ball Valve

KD VALVE supplies with standard manual operators for metal seated ball valves. All valves are designed with standard top flange ISO 5211 for easy mounting of remote actuating systems.

Special Products for High Erosion Service

High pressure drop and rise, high temperature, erosive fluids can easily damage and wore out any surface or material. It is difficult and expensive to maintain a product made using conventional materials. KDVALVE uses our own metallurgical innovation to produce a high hardness product that handles the most extreme severe conditions and still perform exceptionally.



- **Range:**
#150~#2500 / 1/2 inch~32 inch
- **Standard :**
API, ANSI, ASME, DIN, User Spec, etc
- **Leakage Class :**
ANSI B16.104 (FCI 70-2) Class VI

Design Features



- + Bubble tight bi-directional
- + Scraper seat design
- + Protects sealing surface of ball seat
- + Removes particles, foreign object, slurry, etc.
- + High Hardness of over HV2,000
- + Pocketless Design
- + Prevents buildup of solids inside the valve's body dead space
- + ISO5211 mounting plate for actuator



- + Fugitive emissions sealing
- + Standard full port design
- + Variety of construction materials
- + Multi Layer packing protect external leakage
- + The seat spring provides ultimate sealing due to its elasticity during severe situations
- + Wide selection of options for the stem is available
- + Live loaded Packing assures reliable performance
- + Stem sealing requires no maintenance and gives low torque
- + Anti-blowout stem
- + Trunnion mounted and floating ball designs
- + Full and reduced bore designs
- + Jam free at high temperature
- + Spring loaded seats results in bubble tight sealing at low pressure



Quality Assurance | Inspection

The severe conditions of plants require exceptionally high-quality products in order to yield the best results. We at KD VALVE listen to the requirements of the clients to provide best-in-class metal seated ball valves. It is a commitment for us to provide the best quality, so we select raw materials, design, manufacture, assemble, and inspect every unit built in order to make sure it holds up to our high standards. We have gained trust from many major companies in the industries we serve. Our quality control program works to exceed the required standards and undergoes any user specific inspection. The results went beyond clients' expectation and they are available for review.

Safety is a big part of our commitment, and as such we conduct inspection on every single unit we manufacture. We can guarantee that our product will have long life cycle, bring performance to the next level, and let the clients implement the highest standard of safety in their plants. Unlike other brands, we supervise and inspect every manufacturing unit for every client order. That method enables us to ensure that KD VALVEs are free of any defect and problem and that they hold their integrity and deliver a unrivaled performance exceeding clients expectations. Our designers and team of experts conduct guarantee our clients the best service.



- + Bubble Tight Bi-directional
- + Scraper Seat Design
- + High Hardness of over HV2000
- + Pocketless Design
- + Fugitive Emissions Sealing
- + Live Loaded Packing assures reliable performance
- + High Temperature

KYUNG DUK
KYUNG DUK INDUSTRY CO., LTD.

4 Maegoksaneop 1-gil, Buk-gu, Ulsan, Korea
tel. +82-52-297-9586 fax. +82-52-297-9587

2nd Factory

35-1, Seonghye 1-gil, Buk-gu, Ulsan, Korea
tel. +82-52-297-9586 fax. +82-52-297-9587